

“THE ROAD TO SUCCESS
IS ALWAYS UNDER
CONSTRUCTION,,

ATOZ Infra Projects Pvt. Ltd.

www.atozinfraprojects.com



Satisfaction Matters
CONSTRUCTION, CONSULTANCY
AND BEYOND

- ❖ **Engineering**
- ❖ **Procurement**
- ❖ **Construction**



Contractors.



Builders.



Designers.



Engineers.



PEB or Steel Structure.



Electrical Work.



From The Desk of Director

When the company was founded, the main aim was to provide quality services that met with customer's expectation with on time delivery of projects. After 20 years of being associated with the company, I can definitely say that the company has remained true to its motto "Satisfaction Matters." Not only we have expanded into other spheres of construction business but we also have forged a lasting relationship with our customers.

Keeping the future in mind, we intend to stick with the mantra of fulfilling the obligations of our customers on time and with the highest standard of work. We are going to move forward but we are never going to forget the humble beginnings and the guiding principle on which the company has grown.



Mr. Vikash Jaiswal

From The Desk of Managing Director



The industrial construction industry remains a fickle one. Here, if you have to stay afloat in the market you have to perform. When I joined the business in 2002 it was still in a nascent stage although it was a decade since its inception. With a singular aim of the expanding our client base, marketing on war footing was undertaken. This led to increase in our customer base. Now we can boast of having major companies such as Idea, Nokia, Ericsson, Bharti Airtel, Frick India, Kingfisher, Nagarjuna Cement and DRS Group as our clients and this list is constantly growing.

From Industrial construction we have now expanded to school, hospital, public housing, warehouses, civil engineering and infrastructure products. These projects are spread all over India, showing how much we have grown over the years. We are now not only a well-known brand in the construction market but are respected by our peers also....

With each passing year if there is one thing I am sure of, it is that of the enormous strides the company has taken and will keep taking in the field of infrastructure construction.



Mr. Arshad K.
+91 9810710886

KEY PERSONS

Mr. Sushil Kumar Sharma (Sr. Business Development Manager)

He is an accomplished Mechanical Engineer Having B.E (Mechanical) with more than 25 years experience in the fields of projects management. Having worked with prestigious organization in India. He is instrumental in furtherance organizational goals of sustainable business development aiming at continued and consistent growth.

Mr. Mukhtyar (Business Development Manager)

Manages civil project management & leadership, procurement, techno-commercial operations, vender management and design management, astute leader with a flair for adoption modern project execution methodologies and systems in compliance with set quality standards. Monitoring and resources balancing skills and ability to handle multiple function in high pressure environments with tight deadlines



ABOUT US



ATOZ Infra Projects is one of the leading Consultancy and Construction Company based out of Bhiwadi with its branch office in Delhi, having operations all over India. Founded in the year 1995 and established as a company in 2004, company has flourished and grown over the years providing unbeatable quality standards and timely delivery, employing over 950 people across various spectrums of the business. ATOZ Group enwrapped in industrial, commercial and residential sector, has been delivering output more than client's expectations with their timely delivery and quality standards. With the growing demand of industrial construction and warehousing requirement because of the high consumption demand, we need faster delivery with a full stop solution under one roof, because ATOZ Group is able to fill that void, we have a growing customer base without losing the ones who are with us from the time of inception. Starting from scratch of having only 1 customer, today we have more than 200+ satisfied customer. Because of our ethics, work culture, transparency and unbeatable services, 60% of the business is being derived from the word of mouth publicity. With the vision of anticipating our services across the globe, we also aim to expand ourselves to other horizons of the industry, continuing to provide better solutions at unbeatable prices.



MISSION

ATOZ Infra is on a mission to provide excellent services and product to enable customer get value for each penny. Emphasis is on creating a platform where we understand customer's requirement better than them and our solutions provided are best possible. ATOZ Infra is on a mission to blend exuberance of youth with maturity of experience to give perfect services.



Vision

We envision ourselves to be a leader in designing and construction of high tolerance and impact free buildings, satisfying customers with efficient & innovative design that are built with the latest technology in construction. ATOZ Infra is committed to create a brand in industry where it is considered synonyms of ethics, quality and excellence in performance. ATOZ Infra will bring innovation in designs and products to improve the performance in the construction industry.



QUALITY MANAGEMENT SYSTEM

Certificate of Registration

This is to Certify That The Quality Management System of

ATOZ INFRAPROJECTS PRIVATE LIMITED
H. NO. 270, VILL. CHATTERPUR, NEW DELHI - 110074 (INDIA)

has been assessed and found to conform to the requirements of

ISO 9001:2015
for the following scope :

PROVIDING CONSTRUCTION CIVIL WORK &
PEB BUILDING SERVICES

Certificate No	19DQEN95	Issuance Date	: 01/06/2019
Initial Registration Date	: 01/06/2019	Date of Expiry*	: 31/05/2022
Date of Expiry*	: 31/05/2022	1st Surve. Due	: 01/05/2020
1st Surve. Due	: 01/05/2020	2nd Surve. Due	: 01/05/2021

QUALITY MANAGEMENT SYSTEM

Director
DIRECTOR

ROHS Certification Pvt. Ltd.

1405, Shivakrishna Building, 10th Floor, Main, Area 7/11/1, 28th Mile, Hosur
phone : +91 82 4352032 | e-mail : info@rohs-certification.com | website : www.rohs-certification.com
The Registration is made a Product Quality Certificate. *Subject to successful completion of surveillance audits. Visit for registration on www.rohs-certification.com
Certificate is the property of ROHS and others will not be allowed.

035-CB-QMS

PERSONALIZED TECHNICAL SERVICES TO CUSTOMER

Knowledge sharing principles and processed for best selection of product and available technology by customer. This include requirement assessment of customer, meeting quality standard of services, evaluation of customer requirement and satisfaction economically.

YOU CAN DEPEND ON US

The combination of vision, Innovation, precision & manpower has made us strong. Our Customer appreciate our solid reliability & proverbial flexibility when it comes down to supplying even the most complicated solutions economically & on schedule.

OUR CONTINUITY

Continuity also demands vision. Vision is the basis for the Endeavour & solutions that are hardly possible otherwise. Our visionary potential can be found in our technical team,

QUALITY POLICY

Execute project maintaining the highest quality standards systems and safety standards as per global norms.

To provide best services and solutions that reduces the long term maintenance cost of the client and to ensure efficient plus timely delivery of the project.

Our USP's:

- One of the few companies In India to heavily invest on most Experienced team to handle all your needs
- Timely delivery, quick service, best quality and unbeatable prices.
- Third party audit of erection
- One stop solution that saves time, energy and bring more efficiency in work
- Ethical values in marketing has enabled higher customer retention.
- Highly experienced erection procedure, team and third party certification makes erection hassle free and managed in time lines.



Project Execution Methodology

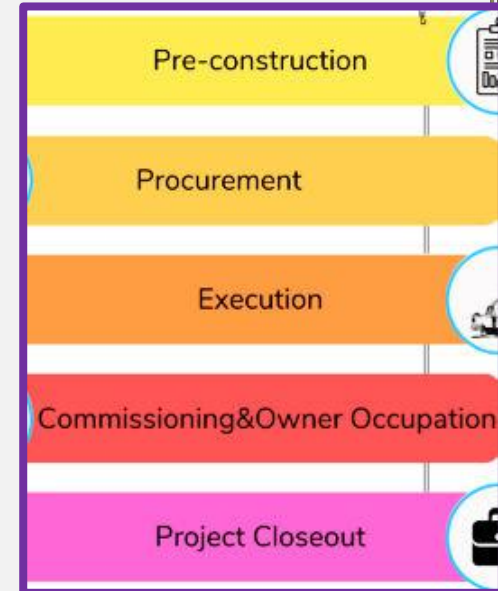
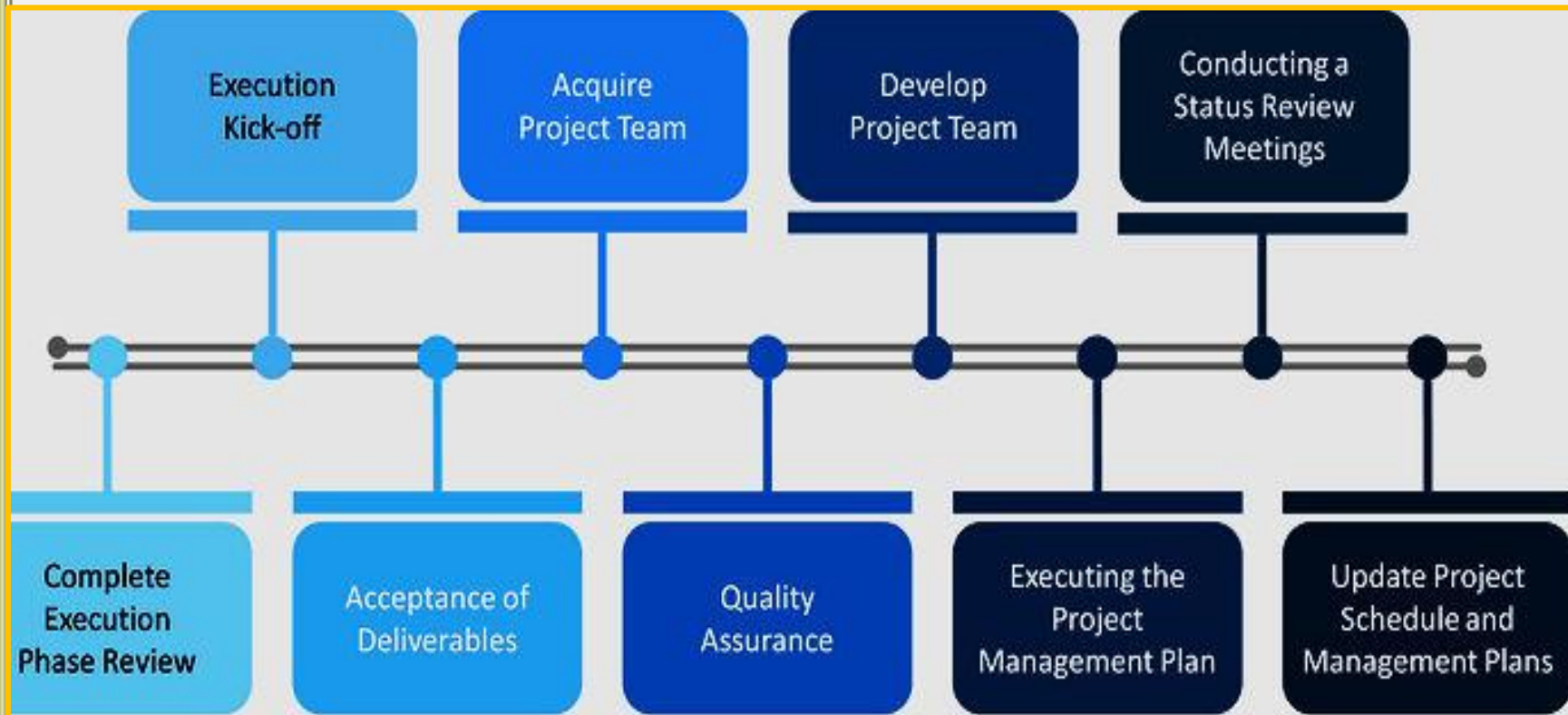
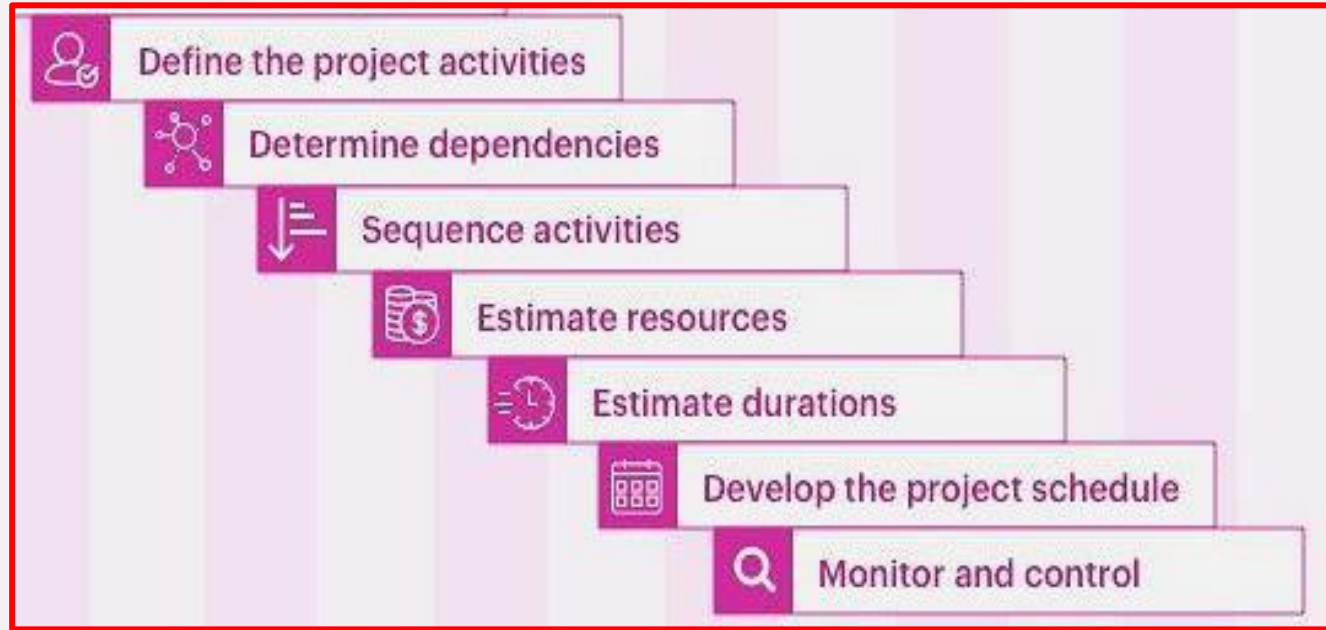

SERVICES WE OFFER

Pre-Construction Services

(Conceptualisation, Development services, preparation of HSE Management, Project subsidies approval, Land Acquisition Consulting)

1. Civil Construction

5. Industrial Flooring

2. Pre Engineered Building

6. Fire Fighting Services

3. Electrical Works

7. Interior Work

4. Design and Detailed Engineering Services

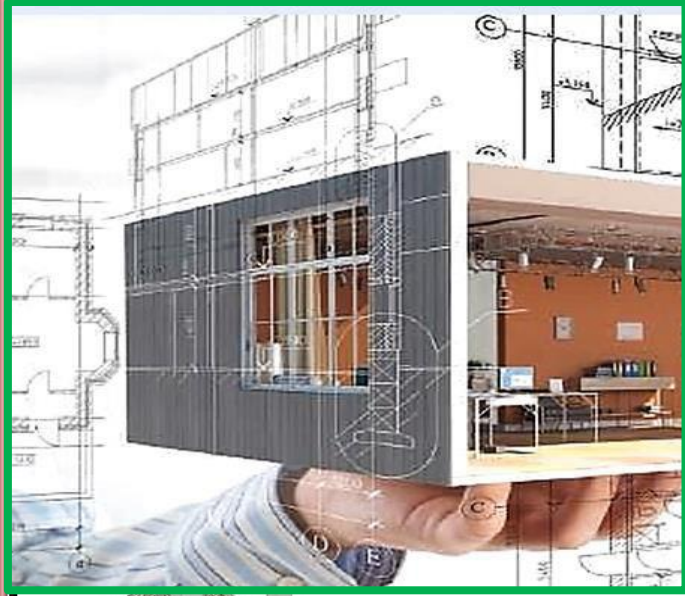





Design & Detailed Engineering Services

The engineering department uses the latest versions of internationally renowned industry-standard 3D and 2D software for designing and detailing. ATOZ Infra upholds its position at the cutting edge of the industry due to its commitment to quality and customer satisfaction. Skilled structural engineers using the very latest in computerized engineering design and detailing systems permit the selection of the most economical accurate and efficient framing and cladding systems.

The Design / Engineering Department is fully computerized, utilizing the latest software package to enable them to produce the most economical structures in the shortest time possible. The software packages most frequently used are

CORE

-  Bureau of Indian Standards IS-800, IS-801, IS-875 & IS-1893(BIS)
-  American Iron and Steel Institute (AISI)
-  American Institute of Steel Construction (AISC)
-  Metal Building Manufacturers Association

STAAD.Pro

Autodesk

Tekla



Urban Planning



Drawings

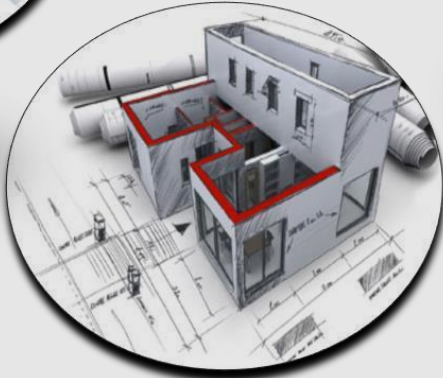

Tender and BOQ

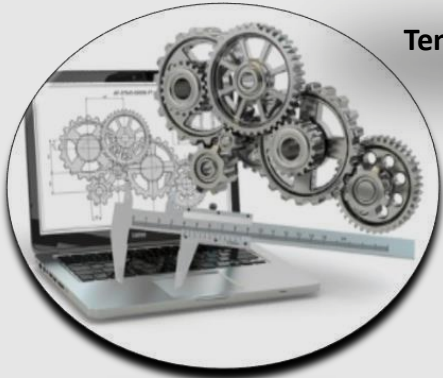

Detailed Engineering Design



Infrastructure and Utilities



Planning



Environmental Planning

Our extensive range of services includes:

Civil Construction



R.C.C. Buildings



PEB or Steel Structure - Warehouses

Our extensive range of services includes:

Civil Construction



Foundation



Excavation & Grading



Building Pads



Underground Utilities

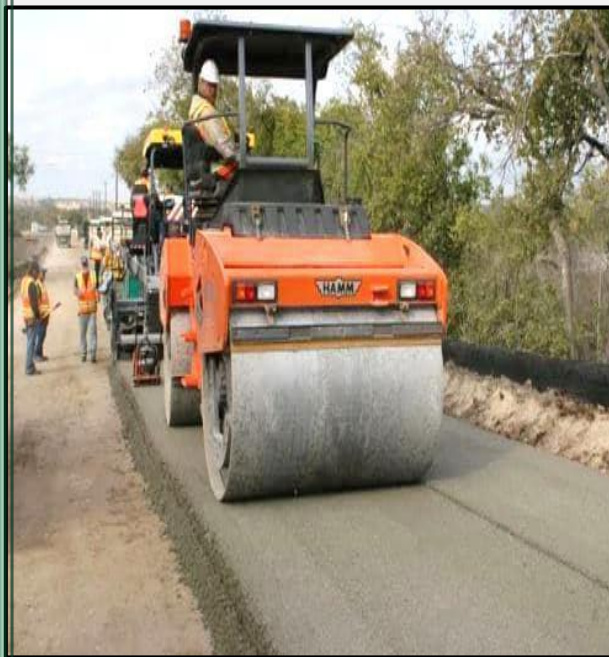

Roads & Parking Areas



Erosion Control



Sidewalks & Curbs



Boundary Walls

From Interstate work, to resurfacing local streets and parking areas, to complete site development services for GCs and developers, ATOZ Infraprojects provides high-quality results at competitive prices, backed by decades of proven experience.

Our reputation for excellence was built by providing high-quality, cost-effective contracting services to the public and private sectors. For years, the foundation of our success has been striving for complete customer satisfaction in every aspect of our work. We invite you to experience this high level of customer service, starting with a prompt review and competitive bid on your next project

Our extensive range of services includes:

Civil Construction



Our extensive range of services includes:

Civil Construction



Pre Engineered Buildings

India is a land of opportunities and industrial development. Pre-engineered building has risen in market share due to various reasons such as speed, economy and quality.

Even after so many years of pre-engineered buildings in India, there is still a gap in a perfect blend of economy, quality, speed and ethics. ATOZ Infra-Projects wishes to create their own mark in rising to a level of expectancy of market. They acquire infrastructure and experienced man power to fulfill their dream of making a mark into all types of industrial construction.

ATOZ knows that to reach perfection they should have the best man power and best infrastructure available in any PEB company.

To reach their target of achieving both they have their associations with the most leading brands of PEB in India, to provide the full stop solution in any part of the country

Manufacturing Unit



FRAMING

ATOZ Infra

Pre- Engineering buildings are designed & Constructed in variety of Frames to meet specific project requirement of client, for maximum utilization of space with excellent strength and highest safety standard. Most commonly used framing system are shown

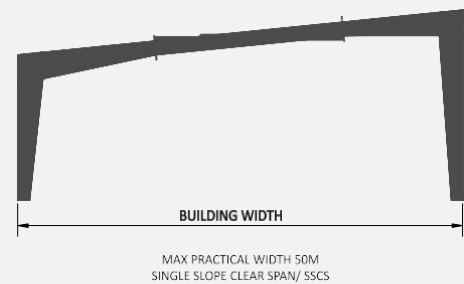
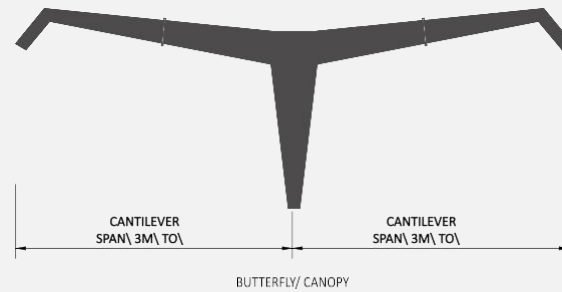
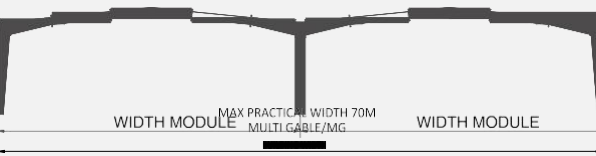
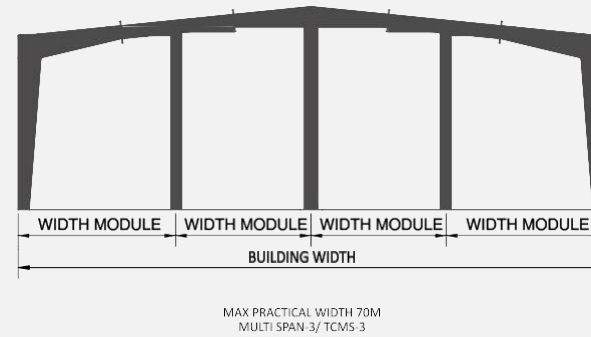
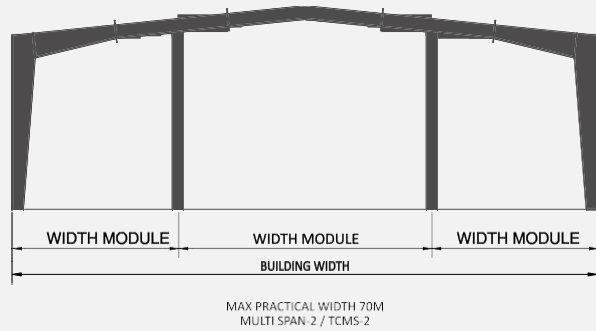
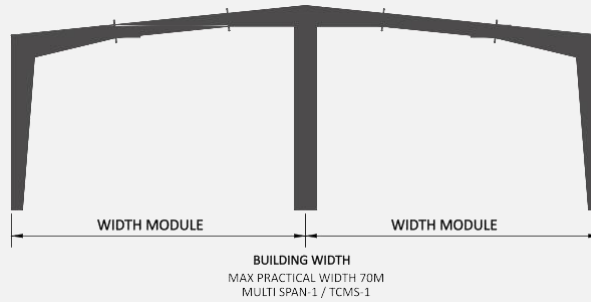
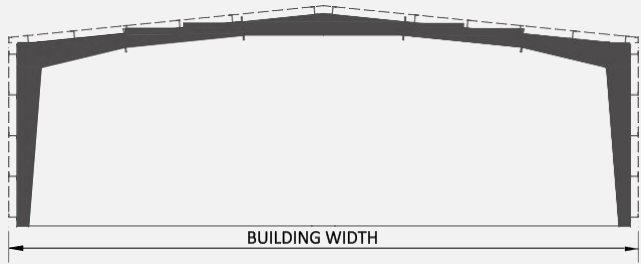

Mezzanine System

Intermediate mezzanine floors are possible in metal buildings. Mezzanine floors can be provided in complete or partial area in pre-engineered buildings to suit loading requirements for office and storage. Mezzanine floors consists of steel decks, supported by joists framed to the mezzanine beams. Mezzanine main beams normally runs across the width of the building and are located under the main rafters while joists run parallel to the length of the building, the top flange of the joist fit perfectly below the top flange of the mezzanine beam. The economy of the mezzanine floor is affected by the applied load and support column spacing. Multilevel equipment platforms, catwalks, staircases etc. can be accommodated, if complete data is available.

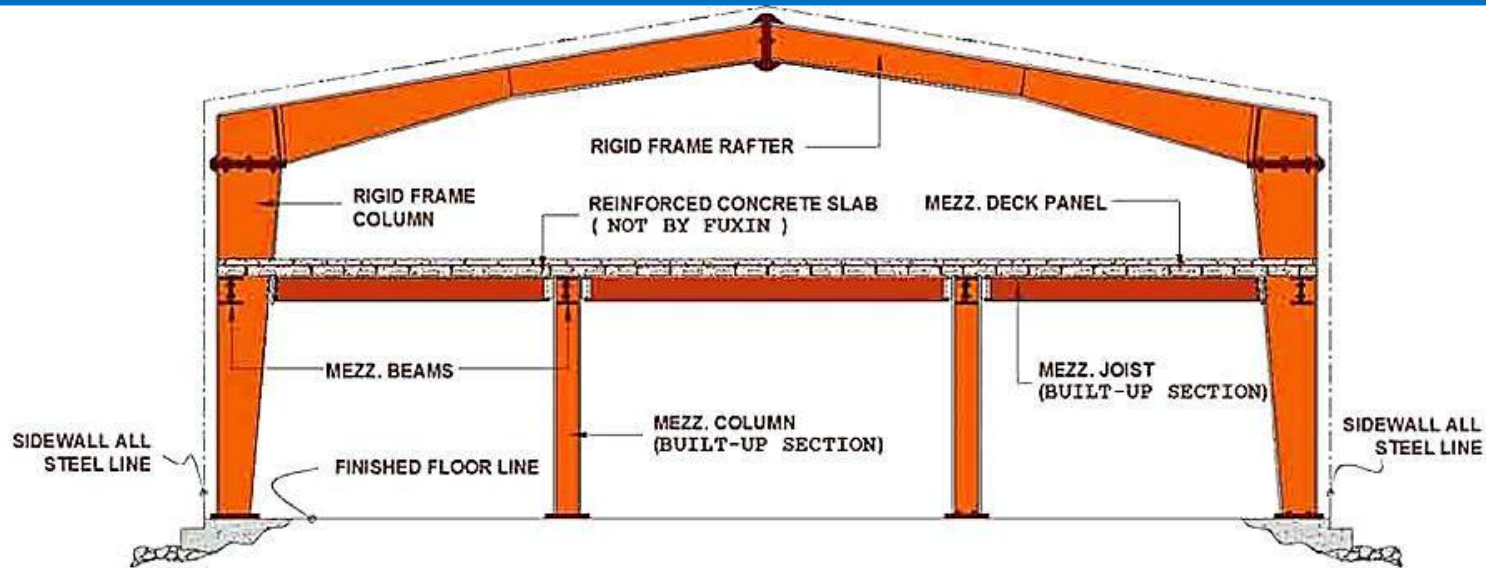

ELEVATION : MEZZANINE CROSS SECTION

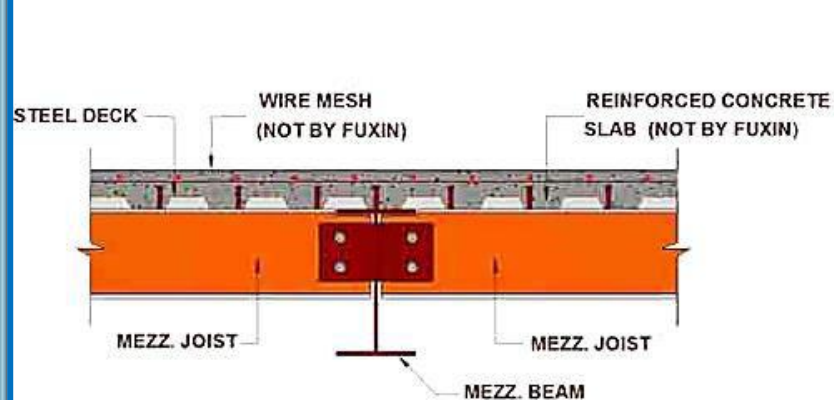
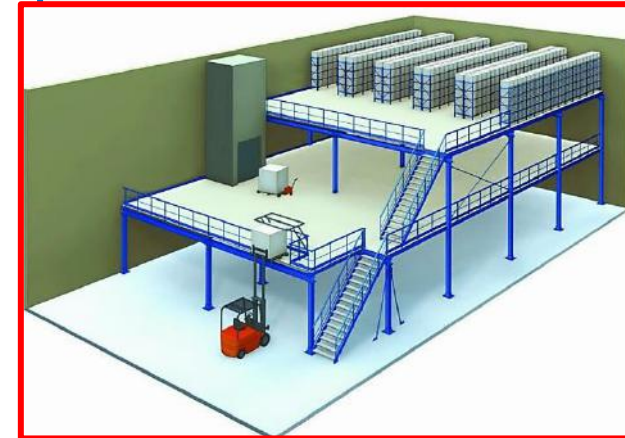

MEZZ. JOIST CONNECTION TO MEZZ. BEAM

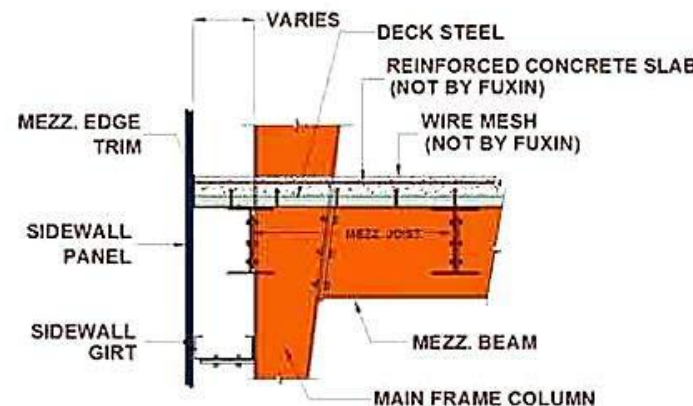

MEZZ. BEAM CONNECTION TO MAIN COLUMN



Crane

ATOZ Infra Provides Design for Pre-Engineered Building of Crane system like EOT, Monorail, Underhung and Other Device such as convery. Balarka Scope involves supply of Rafter Bracket and crane runway beam that support the crane system.

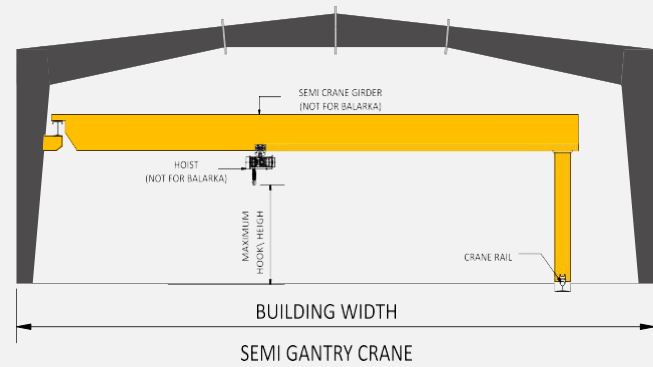
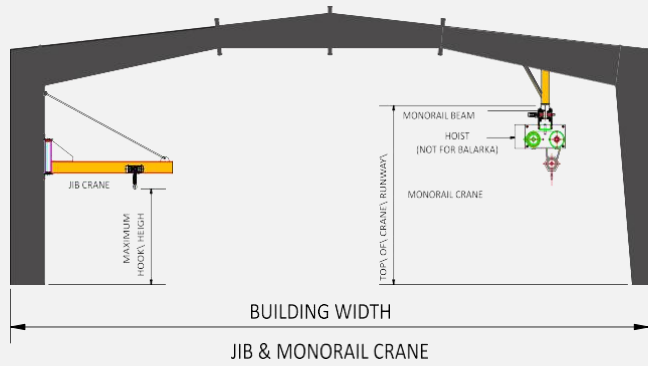
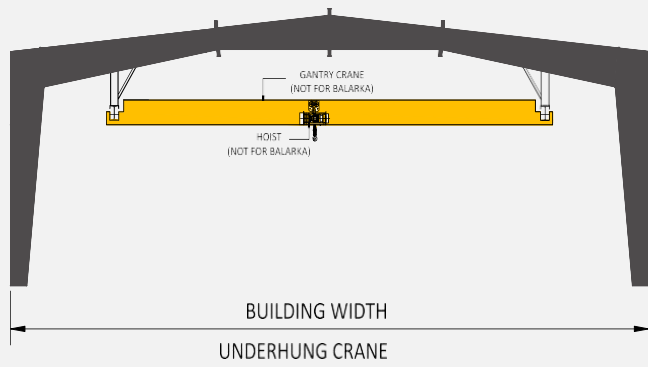
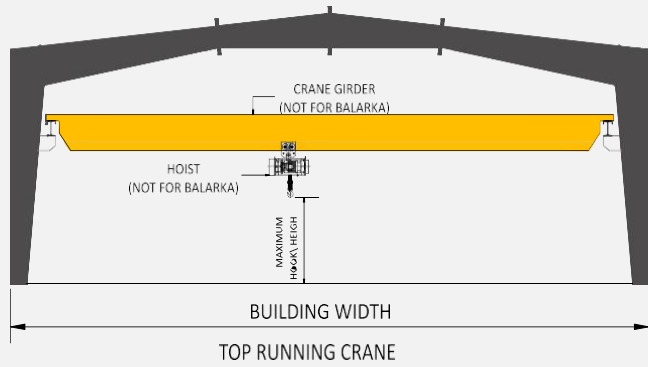

Electrical Work

OUR TURNKEY SERVICES

- 33 KV, 11 KV Sub-Stations
- Cable Laying In Trench Or In Ground
- Cable Jointing And Termination
- Insulations Testing of Electrical Equipments
- Switch Boards & Switch Gears
- Earthing & Earth Grids
- Electrical Design & Testing
- Installation Of LT & HT Panel
- Installation Of CCTV System
- Fabrication Of MS Structure For Machine Stand, Tray, Fan Support, ETC
- Street Light Pole Installation
- Industrial Wiring
- Lighting & Power
- Erection Of Perforated Tray/Ladder Type Tray
- Electrical Instruments
- PLC & SCADA Wiring
- Data Cabling & IT Works
- Solar Project
- Lightning Arrester Installation
- Service Maintenance & Testing
- Capacitor Banks

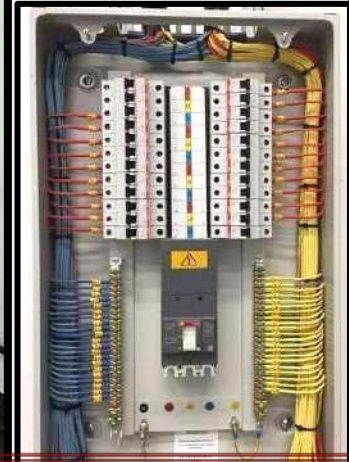

Electrical Work



Electrical Panels Manufacturing Unit



Flooring System

- 1. Industrial Flooring:
- 2. Concrete Flooring
- 3. Super Flat Flooring
- 4. Steel Armour Joints
- 5. Floor Hardening Systems
- 6. Polished Concrete Systems
- 7. SFRC Jointless Flooring
- 8. Floor Repair and Restoration



INDUSTRIAL FLOORING



CONCRETE FLOORING



SUPER FLAT FLOORING



STEEL ARMOUR JOINTS



FLOOR HARDENING SYSTEM



POLISHED CONCRETE SYSTEMS



SFRC JOINTLESS FLOORING



FLOOR REPAIR AND RESTORAT

Fire Fighting

ATOZ Infra has made a commitment to save the lives of firefighters around the globe by producing products that assist in rehabilitation on emergency scenes. There have been multiple studies conducted that evaluated the causes of injuries and deaths of firefighters as well as the amount of money spent on treatment and replacement due to lost time. HeatSeeker Technology & Design, LLC is making rehab a tactical consideration.



Interior Work

Painting and Polishing
Work Wood Work
POP Work Ceiling
Work Glass Work
Office workstation
Furniture Partitions



List of Equipment's, Tools , Machineries



Batching Plants with Concrete pump (1m3 Capacity)

2 Nos

Loader

3 Nos

Dumper

9 Nos

Earth Compactors

10 Nos

Cube Test Machines

8 Nos

Tractor/ Trolley/ Water tanks

4 Nos

Cube Moulds

100 Nos

Concrete Mixer Machines

20 Nos

Monkey Lifts

15 Nos

Tower Hoists

2 Nos

Bar Cutting machine

14 Nos

Bar Bending machines

8 Nos

Modern scaffolding

1 Lc Sqft

D. G. set Small/ Big

4 Nos

Dumpy Level

4 Nos

Theodolite

2 Nos

Dismantling Hammer Machine

10 Nos

Slit Testing M/c

12 Nos

All Lab. equipment's

YES

Compaction M/n

2 Nos

Transit Mixers

4 Nos

WMM Plant

2 Nos

JCB – 2 nos. Stream Curing Plant – 2 nos.

2 Nos

Vibrators

25 nos

Monkey Lift

6 Nos

Tipper

10 Nos

Motor grader

4 Nos

Vibratos rollers

1 Nos

Tandem Vibratory rollers

2 Nos

Total Station

2 Nos

Auto Leveller

20 Nos

Jack Hammer

10 Nos

Air compressor

4 Nos

Health & Safety



We are dedicated to providing a safe environment for our employees to work in. Adherence to various rules and regulations laid down by the government and going even beyond them so that our employees remain healthy and free from ailments.

Regular health check-ups are organized for the employees. Not only that, all the employees are provided with various protective gears for onsite jobs. These gears such as helmets, masks, safety harness etc, meet the various standards stipulated and regularly examined to check for any wear and tears and are regularly replaced with new gears.

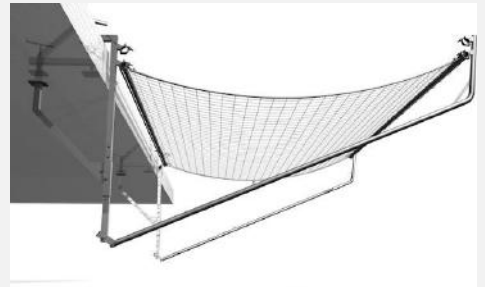

Keeping in line with the vision of Swachh Bharat Abhiyan, we try to maintain the cleanliness of the surroundings of the job site. We also provide eco-friendly sanitation solutions for employees at the worksite.



We also follow the rules and regulations regarding environmental safety. An environmental audit is carried out for most of the sites. Every order of the government, court or NGT in regards to pollution or environmental production is strictly adhered with.

Our Completed Projects



LEADING METALLOYS, KAROLI, BHIWADI



LEADING METALLOYS, KAROLI, BHIWADI



MALHOTRA CABLES PVT LTD, KAHARANI, BHIWADI



MALHOTRA CABLES PVT LTD, KAHARANI, BHIWADI

Our Completed Projects



ELCINA Electronics Manufacturing Cluster,



LEADING METALLOYS, KAROLI, BHIWADI



DHOOT TRANSMISSION PRIVATE LIMITED, MANASER SSECTOR - 8, GURGAON



Our Completed Projects



ELCINA ELECTRONICS MANUFACTURING CLUSTER, BHIWADI, RAJASTHAN, KHUSHKHERA 35



RAF STATIONARY MFG CO. SECTOR-85, NOIDA, UTTAR PRADESH

Our Completed Projects



MAHLOTRA CABLES (Unit 2)



MAHLOTRA CABLES (Unit 2)



HIND TERMINAL

Our Completed Projects



TARUDHAN VALLEY



TARUDHAN VALLEY



AGARWAL MOVERS

Our Completed Projects



TARUDHAN VALLEY Golf Resort Manesar (Hr.)



INDUS PHARMA PVT. LTD

Ind. Area- Ghiloth(Raj.)



BIHANI MANUFACTURING



SHREE KRISHNA TOWER



HITESH HERBOTECH



MPS, BHIWADI

Our Completed Projects



MATHESON K-AIR



MATHESON K-AIR



ORIENT CRAFT



ORIENT CRAFT

Our Completed Projects



RANI POLYMERS



NCL



MYSTIC GREENS



TRUTH INDIA

Our Completed Projects



AVALON ROSEWOOD



BHARTI AIRTEL



BHARTI AIRTEL



AVALON RESIDENCY

Our Completed Projects



VIVA DRY MIX PVT. LTD



CONTINENTAL PRAGATI

Our Completed Projects



ELEMATIC INDIA PRIVATE LIMITED

MIA - Alwar (Raj.)

Corporate Social Responsibility



Corporate Social Responsibility:

The ATOZ Infra is involved in various social activities. It has been associated with the NGO Astha for years and has been providing education to underprivileged children through it. It also recently undertook major renovation of the building that housed the school run by the NGO.

Another NGO the Group has been associated with is Mogli, where all the education needs and meals of the children are sponsored by the ATOZ Infra

Other than this, plantation drive has been undertaken by the group on the occasion of World Environment Day (5 June).

Our Valuable Clients



Indica



LohiaCorp



MODERN PUBLIC SCHOOL
Bhiwadi (Rajasthan)



amr

CONCRETE PLANNERS



MODERN PUBLIC SCHOOL BHIWADI
ISO 9001:2015 Certified

Floor Flatness Surveying & Consulting Services

www.atozinfraprojects.com

ATOZ InfraProjects Pvt. Ltd.

Corporate Office :- A-102, 1st floor, Ganpati Plaza, Bhiwadi, Alwar-301019 (Rajasthan)

Registered Office :- C-141, Lower Ground, Kh.No. 279, Chattarpur Enclave, Phase-II, New Delhi-74, INDIA

Email Us :- atoz.bdm@gmail.com, bdm@atozinfraprojects.com

Mr. Mukhtyar (BDM) :- +91-9784985187, +91-9810226886

Follow us



INDIA